

We make
fire...
better.



earthcore®

Luxury
Hearth & Patio
Products



earthcore®

The need to connect with fire is elemental to the human experience. Harnessing its power distinguishes us. Protects us. Comforts us.

While we can never touch fire ourselves, it invariably finds ways to touch us — kindling our memories, igniting our passions, warming our hearts. Fire reminds us how alive we are.

Recognizing this in everything Earthcore does, with every product we create, we strive to reconnect you with the beautiful, captivating, power of fire — in the comfort of your home.

Safely. Efficiently. Artfully. Naturally. With an inexhaustible passion to make any home design you can dream of possible. Using only the finest building materials, Earthcore's reputation for innovation and superior quality make us more than the unquestioned leader in the custom fireplace and outdoor kitchen and living category. They make us the #1 choice of architects, designers and builders since 1989.



WHY CHOOSE ISOKERN?

A Name Built on Trust

Our fireplaces are designed for your home, but our company was designed around your needs. With over 80 years of unparalleled performance in the chimney and fireplace industry, the Isokern line has become the most trusted modular system in the world. Since 1989, in North America, Earthcore has proudly provided exceptional products combined with unmatched customer service from our 10 solution centers and dedicated network of over 600 dealers.

Setting the Standard for Raising Temperatures

Where most fireplace manufacturers stop, Earthcore's just getting warmed up. Utilizing the GreenTech Solution, all Isokern wood burning fireplaces are **EPA Phase 2** qualified and are tested and listed to the highest standards in the United States and Canada.

Easy Installation and Comparative Pricing

We are focused on spreading warmth without anyone getting hot under the collar. Earthcore's Isokern Fireplace & Chimney System modular components are specially designed to make your installation a breeze. Due to the material's properties, the components are lightweight, while retaining UL 127 and UL 103HT (respectively) listings. Similar looking components made by others are concrete which do not have the refractive or insulative properties as our pumice. Consequently, our modular Isokern Fireplace & Chimney Systems are less expensive to install than traditional masonry fireplaces. And, unlike typical metal box fireplaces or brick/block systems, they are built to last forever.

Custom-Design Service for Your Fireplace Project

At Earthcore, fireplaces are more than sources of heat. They are works of art. Put your signature on a truly one-of-a-kind fireplace with our Isokern customization services. To see how we can help you construct your personal masterpiece, contact your local distributor/dealer for details. Custom fireplace acceptance is based on local jurisdictions and codes. See pages 9-19 to explore the possibilities.

Born in the Fiery Heart of Mt. Hekla

Extracted from Iceland's Mt. Hekla volcano, our Isokern and Iso'ven products are made from volcanic pumice. Earthcore has exclusive rights to mine this high-grade material from a 25-mile long volcanic fissure and the volcano itself, which rises to a height of 5,000 feet. Estimated at approximately 3,500 years old, central volcanoes like Mt. Hekla can remain active for around 100,000 years according to geologists. With durability like that, it's no wonder our fireplaces are guaranteed for life.

From the Center of the Earth to Chesapeake, Virginia

Pressure, time and heat. These are a few factors that make Isokern fireplaces unlike any other. Formed in Iceland from the volcanic magma core, our pumice ships directly from the source to the Earthcore manufacturing facility in Chesapeake, Virginia, where it's pressed into modular fireplace and chimney components. This process takes place in our efficient automated state-of-the-art facility and operates under strict quality-controlled guidelines, resulting in Earthcore's environmentally safe, incredibly efficient fireplaces, chimneys, outdoor kitchen panels, and wood burning ovens.

Made to Stand the Test of Time

Through years of dedication, R&D, quality control and stringent testing, Earthcore's Isokern Fireplaces & Chimney Systems have turned up the heat on the heating industry by making products that are easy to install, lightweight, safe, affordable and built to last. We guarantee each Earthcore product with a Lifetime Warranty that protects against manufacturer defects, so you can expect countless years of joy as you celebrate the timeless pleasures of a beautiful fire with Isokern.

BEHIND EVERY BEAUTIFUL FIREPLACE IS AN ISOKERN.

FIRE. The word alone conveys a representation of survival, danger, heat, and entertainment. In many places around the world, FIRE is used as a source of survival. From cooking meals to boiling fresh water, it is a life source for families to sustain their existence. Yet, here in North America we have the luxury of using FIRE for entertainment around the holidays, events, and wintry seasons. Although there are many companies that produce similar types of enclosures utilizing steel boxes or concrete, our ambitions have always been to utilize the best known materials to surround your FIRE. Made from the purest volcanic material, exclusively sourced from Iceland, our Isokern fireplaces and chimneys continually meet the demands of consumers with a one-on-one design basis. With 600 dealers, 10 regional locations, and

more than 500,000

units operating,

at Earthcore

We Make Fire... Better.



Carl R. Spadaro

Founder of Earthcore

CONTENT

Isokern Fireplaces

Standard Series	8
Magnum Series	9
Maximus Series	12
Fire-Lite Application	14
IBV Series	15
Vent-Free Series	17

Multi-Venting Solutions 21

Isokern Chimney Solutions

DM54 Chimney System	23
EM40 Mono Chimney	23
DM44 Appliance Chimney System	23
Brick Ledge	23
Offset Block	23
Eco-Steel Venting Solutions	24

Isoflames

Custom Linear Solutions	26
The Stadium Burner	26

Iso'ven

Wood Burning Pizza Oven	28
Accessories	28

Isopanel 29

Fireplace & Chimney Accessories 31

Chimney Pots 33

Earthcore Locations and Listings 34



Ⓜ - Earthcore Exclusive

EPA - GREENTECH SOLUTION Ⓜ

Enjoy the warmth of a wood burning fire while contributing to a cleaner environment. As the world's cleanest burning open-hearth masonry fireplace, the Isokern GreenTech Solution from Earthcore reduces particulate emissions by up to 80% and is the largest line of wood burning fireplaces to qualify under the EPA Voluntary Wood Burning Fireplace Program. The GreenTech Solution can be easily installed in a matter of minutes by adding this Earthcore Exclusive(Ⓜ) Catalytic Combustor to any Isokern Magnum or Standard Series fireplace.





Photo Credit: Krzysztof Labanowski



earthcore®

ISOKERN

Revolutionary indoor and outdoor modular refractory fireplaces. Made from the cleanest, purest pumice, sourced exclusively in Iceland, Isokern masonry components cradle the raw power of fire in the safest, most energy-efficient material on earth. Totally customizable, Isokern allows architects and their clients to pursue their most inspired designs, while connecting with the natural beauty of fire in a way that, until now, only nature could.

earthcore®

ISOKERN

The Standard (All Fuel)

NO ONE EVER
CURLS UP NEXT
TO THE FLAT SCREEN TV
WITH A GOOD BOOK.

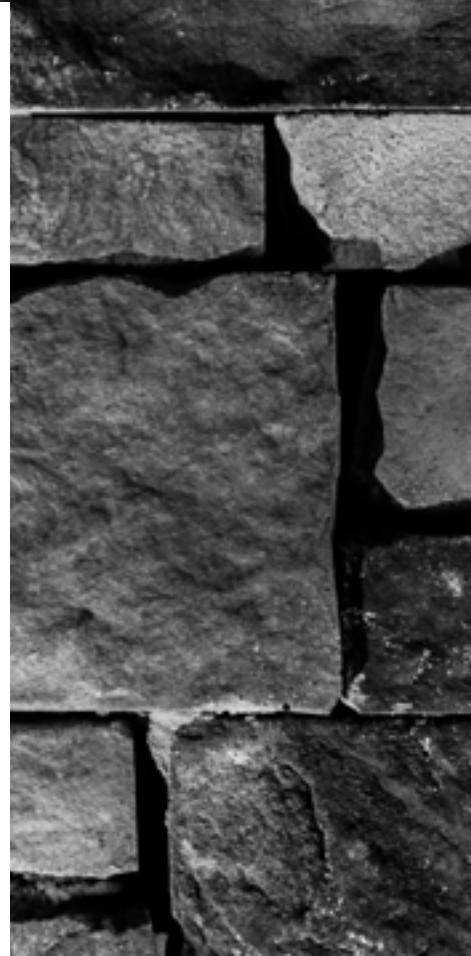



Applications

- Indoor
- Outdoor
- Wood
- Natural Gas
- LP (Liquid Propane)
- Combustible Floor Installation
- Custom Finish
- 2 Sided Opening Availability
- Isokern DM Chimney
- Eco-Steel Chimney

Firebrick Patterns

- Herringbone
- Stack Bond
- Basket Weave
- Running Bond

Firebrick Options

- Square Edged Fulls - Red/Beige
- Square Edged Splits - Red/Beige
- Tumbled Splits - Red/Beige
- Square Edged Soaps - Red/Beige

THE ISOKERN STANDARD SERIES (ALL FUEL)

Make your ideal dream home a dream come true with Isokern's Standard Series. As the first Isokern modular fireplace introduced in the United States, the modular construction of the Standard Series allows you to unleash your creative desires with a fireplace as unique as you are. Whether you choose wood burning or, indoor or outdoor, the Standard Series sets the standard.





earthcore®

ISOKERN

The Magnum (All Fuel)

CRADLED IN STONE,
THE BEAUTY OF
FIRE TAKES US BACK
TO A TIME WHEN IT
DEFINED OUR LIVES.

Applications

Indoor
Outdoor
Wood
Natural Gas
LP (Liquid Propane)
Custom Finish
2 Sided Opening Availability
Isokern DM Chimney
Eco-Steel Chimney

Firebrick Patterns

Herringbone
Stack Bond
Basket Weave
Running Bond

Firebrick Options

Square Edged Fulls - Red/Beige
Square Edged Splits - Red/Beige
Tumbled Splits - Red/Beige
Square Edged Soaps - Red/Beige

THE ISOKERN MAGNUM SERIES (ALL FUEL)

Fan the flames of innovation and take your fireplace to new heights. The Isokern Magnum Series Fireplace System product line offers the largest openings available in the market, with finished width openings of 36", 42", 48", 60" & 72". With Isokern's proprietary straight-back interior design and innovative contoured shelf, the modular Magnum Series produces unequalled efficiency, performance and custom fireplace design flexibility.





earthcore[®]

ISOKERN

The Maximus (Gas Only)

Applications

Indoor
Natural Gas
LP (Liquid Propane)
Combustible Floor
Installation
Custom Finish
Direct Vent Chimney

Firebrick Patterns

Herringbone
Stack Bond
Basket Weave
Running Bond

Firebrick Options

Square Edged Fulls - Red/Beige
Square Edged Splits - Red/Beige
Tumbled Splits - Red/Beige
Square Edged Soaps - Red/Beige

**FIRST EVER MASONRY
DIRECT VENT FIREPLACE.**





THE ISOKERN MAXIMUS SERIES (GAS ONLY)

Put the awe-inspiring power of fire on full display. The Isokern MAXIMUS Series, is the first ever masonry direct vent fireplace. Offering an expansive ceramic glass opening with Invisi-Barrier and Triple Stadium Burner for exceptional appearance and flame presentation. With an array of options, the MAXIMUS provides endless possibilities for making your space warm and inviting.

earthcore®

ISOKERN

Fire-Lite System



FIRE-LITE APPLICATION

1) Isokern Standard Series: Fire-Lite Application

Install just about anywhere.

2) Anchor Plate with Isowool

Required: Installation connection between the Firebox and Eco-Steel Venting Solutions.

3) Isokern Magnum Series: Fire-Lite Application

Take the romantic charm of a wood burning fire into uncharted territory safely. The Fire-Lite Application represents the only modular masonry fireplace application listed and tested to be installed on a combustible floor system. Another first, this innovative (since 1998) application enables architects, builders and designers to specify a wood burning masonry fireplace system in projects that couldn't include one in the past.

Flush Hearth Application

Using the Metal Stand in the Fire-Lite Application, both the Isokern Magnum and Standard Series can be placed directly on a combustible floor or be recessed into any combustible floor system as an approved, listed application with detailed plans available. By knowing the dimensions of your finished floor material, the fireplace can be set to offer a desired, seamless flush hearth. Contact your Earthcore Representative to learn more.

4) Metal Stand

Metal Stand offered in a 4" height for the Isokern Standard and Magnum Series fireplaces. Comes with Isowool.

5) Eco-Steel Venting Solutions

The Eco-Steel Venting Solutions has an easy-to-install, lightweight design, for both gas and solid fuels.

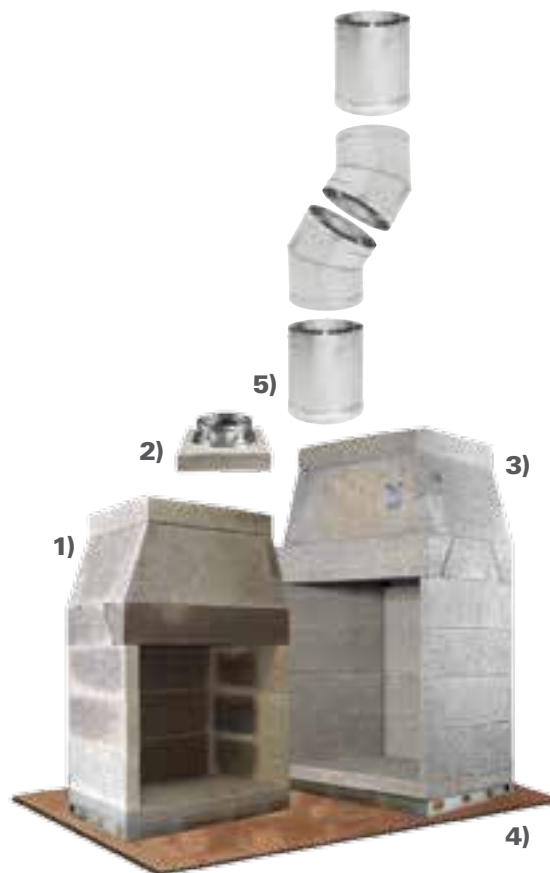

SYSTEM CONTENTS

- 1) Isokern Standard Series: Fire-Lite Application
- 2) Anchor Plate with Isowool ©
- 3) Isokern Magnum Series: Fire-Lite Application
- 4) Metal Stand with Isowool ©
- 5) Eco-Steel Venting Solutions

APPLICATIONS

Indoor	Combustible Floor
Outdoor	Installation
Wood	Custom Finished
Natural Gas	2 Sided Opening
LP (Liquid Propane)	Availability
	Eco-Steel Venting

MODELS AVAILABLE

36, 42, 46, 48





earthcore®

ISOKERN

The B-Vent IBV (Gas Only)

2,500 YEARS IN
THE MAKING.
CLEANER. MORE PURE.
SUPERIOR IN
EVERY QUALITY.

THE ISOKERN B-VENT IBV SERIES (GAS ONLY)

The warm embrace of fire has captivated human beings since the dawn of man kind. The only field-assembled, modular refractory, decorative gas appliance in the market today. The Isokern B-Vent IBV Series has the largest finished opening height of 52" and can be installed directly onto combustible floor systems and meets ANSI Z21.50 standard guidelines. With our proprietary quick fire ignition system, the Isokern IBV comes complete with our exclusive Isoflames Stadium Burner. Isokern's newest log set, the Stadium Burner, has a convenient all Remote Electronic Ignition with an optional wall switch. This reversible set also gives the homeowner two presentation options: oak and split oak.



Applications

Indoor
 Natural Gas
 LP (Liquid Propane)
 Combustible Floor
 Installation
 Custom Finish
 Isokern DM Chimney
 UL 103 Steel Chimney

Firebrick Patterns

Herringbone
 Stack Bond
 Basket Weave
 Running Bond

Firebrick Options

Square Edged Fulls - Red/Beige
 Square Edged Splits - Red/Beige
 Tumbled Splits - Red/Beige
 Square Edged Soaps - Red/Beige

earthcore[®]

ISOKERN

The Vent-Free (Gas Only)

Applications

Indoor
Outdoor
Natural Gas
LP (Liquid Propane)
Combustible Floor
Installation
Custom Finish
2 Sided Availability
Unvented

Firebrick Patterns

Herringbone
Stack Bond
Basket Weave
Running Bond

Firebrick Options

Square Edged Fulls - Red/Beige
Square Edged Splits - Red/Beige
Tumbled Splits - Red/Beige
Square Edged Soaps - Red/Beige



THE ISOKERN VENT-FREE SERIES (GAS ONLY)

Gas fire knows no bounds. Neither should fireplaces. The Vent-Free Series can be installed in less traditional areas of your house or even outdoors. With its large finished openings and double-sided/see-through availability, the Vent-Free Series is perfect in multi-family, new homes, a remodeling design or pool concept. And, unlike other masonry fireplaces, the Vent-Free Series can be installed in hours and is ideal for a variety of applications. This fireplace can also be finished in any way you desire— brick, stone, stucco, tile or veneer.

COMPARE ISOKERN MODULAR MASONRY FIREPLACES

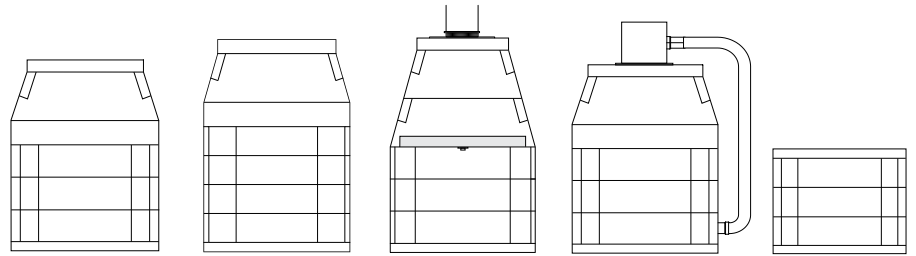

	STANDARD	MAGNUM	IBV	MAXIMUS	VENT-FREE
APPLICATIONS					
Indoor	•	•	•	•	•
Outdoor	•	•			•
Multi-View	•	•			•
Commercial	•	•	•		•
Residential	•	•	•	•	•
Custom Finish	•	•	•	•	•
Masonry Foundation Installation	•	•	•	•	•
Combustible Floor Installation	36"/42"/46" with Fire-Lite* Option	36"/42"/48" with Fire-Lite* Option	•	•	•
GreenTech** (EPA Phase 2 Qualified)	Optional	Optional			
FUEL TYPES					
Wood Burning	•	•			
Natural Gas (NG)	•	•	•	•	•
Liquid Propane (LP)	•	•	•	•	•
VENTING †					
Flue Size	14"	14"	10"	8"	NA
Masonry Chimney	Isokern DM54	Isokern DM54			
Air Cooled Metal Chimney Pipe	UL103 or UL127	UL103 or UL127	10" B-Vent	SV8 Direct Vent	
Insulated Metal Chimney Pipe	UL103	UL103			
eDamper (Electronic Damper)			•		
HEARTH OPENING SIZES †					
28" Model		31" x 28 1/2"			
36" Model	36 1/8" x 31 1/2"	38 3/8" x 38"	36 1/8" x 31 1/2"		36 1/8" x 31 1/2"
42" Model	43 1/8" x 31 1/2"	44 1/2" x 38"			43 1/8" x 31 1/2"
46" Model	47 1/8" x 31 1/2"		47 1/8" x 31 1/2"	39 1/8" x 28 7/8"	47 1/8" x 31 1/2"
48" Model		48 1/2" x 38"		40 1/2" x 35 3/8"	
60" Model (Lintel Required)		69" x 38"			
72" Model (Lintel Required)		81 1/4" x 38"			

*The Fire-Lite application allows select Isokern wood burning fireplaces to be placed on a combustible floor when using the Fire-Lite non combustible 4" tall stand.

**The GreenTech application allows Isokern wood burning fireplaces to be EPA Phase 2 qualified and listed on the EPA Website under the Burn Wise Program.

† Consult manual regarding chimney size and clearances. Hearth opening size is the total viewing area (width x height) prior to firebrick installation.

THE STANDARD SERIES

Page 8

Assembled Firebox and Smoke Dome Dimensions
36, 42, 46

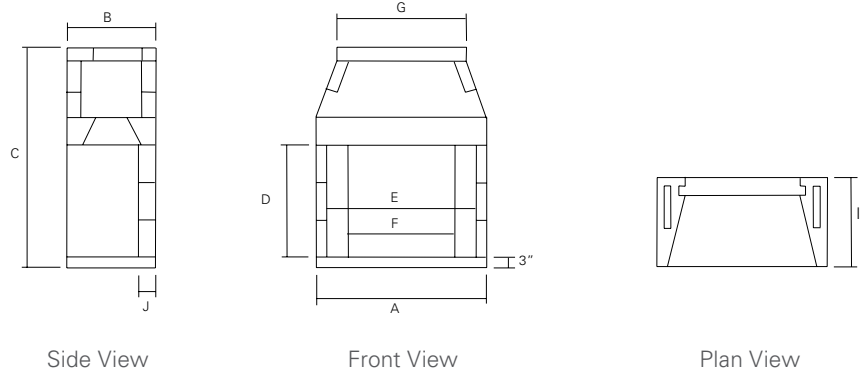

Model	A	B	C	D	E	F	G	I	J	Minimum Framing	Weight
36	43"	25 1/4"	63 1/4"	31 1/2"	36 1/8"	27 1/4"	33"	25 1/4"	5"	(46"w) x (65"h) x (26 3/4"d)	1205 lbs
42	49"	25 1/4"	63 1/4"	31 1/2"	43 1/8"	33 1/4"	33"	25 1/4"	5"	(52"w) x (65"h) x (26 3/4"d)	1325 lbs
46	53"	25 1/4"	63 1/4"	31 1/2"	47 1/8"	37 1/4"	43"	25 1/4"	5"	(56"w) x (65"h) x (26 3/4"d)	1450 lbs

THE MAGNUM SERIES

Page 10

Assembled Firebox and Smoke Dome Dimensions
36, 42, 48, 60 & 72

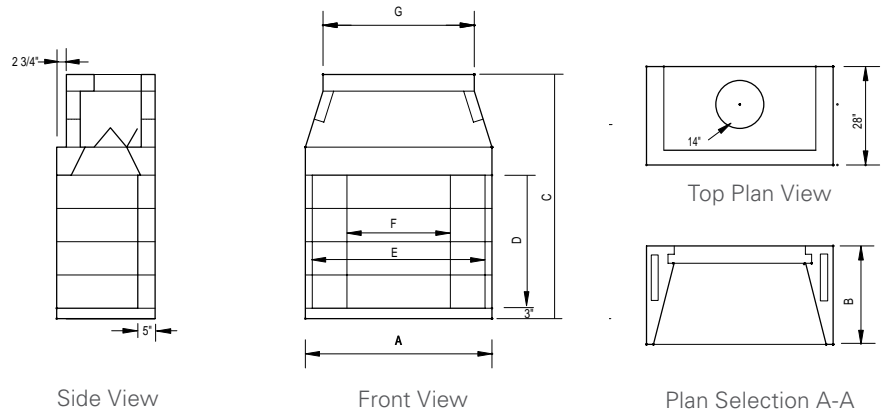

Model	A	B	C	D	E	F	G	Minimum Framing	Weight
36	43"	28"	69 3/4"	38"	38 3/8"	27 1/4"	33"	(46"w) x (71"h) x (29 1/2"d)	1300 lbs
42	49"	28"	69 3/4"	38"	44 1/2"	33 1/4"	33"	(52"w) x (71"h) x (29 1/2"d)	1420 lbs
48	53"	28"	69 3/4"	38"	48 1/2"	37 1/4"	43"	(56"w) x (71"h) x (29 1/2"d)	1600 lbs
60	72 1/2"	28"	85 3/4"	38"	69"	57 1/4"	53 1/2"	(76 1/2"w) x (87 1/4"h) x (29 1/2"d)	2652 lbs
72	85 1/2"	28"	85 3/4"	38"	81 3/4"	69 3/4"	66"	(88 1/2"w) x (87 1/4"h) x (29 1/2"d)	2952 lbs

*Models 60 & 72 come with a double smoke dome and require a steel lintel(not included).

THE MAXIMUS SERIES

Page 12

Assembled Firebox and Smoke Dome Dimensions
46 & 48

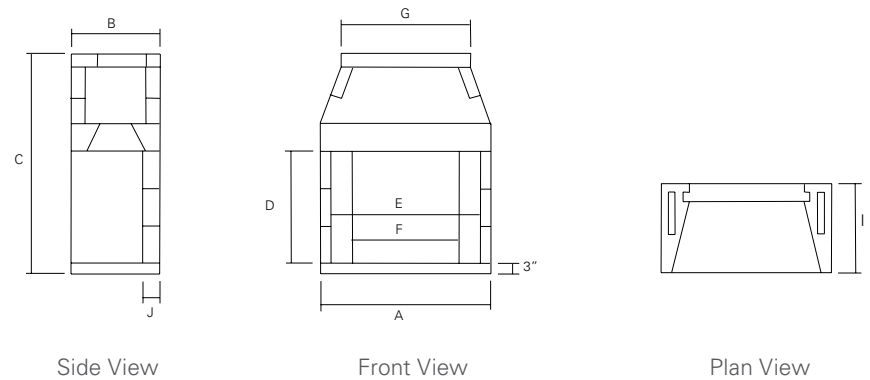

Model	A	B	C	D	E	F	G	I	J	Minimum Framing	Weight
46	53"	25 1/4"	63 1/4"	31 1/2"	47 1/8"	37 1/4"	43"	25 1/4"	5"	(56"w) x (65"h) x (26 3/4"d)	1450 lbs
48	53"	25 1/4"	69 3/4"	38"	48 1/2"	37 1/4"	43"	28"	5"	(56"w) x (71"h) x (29 1/2"d)	1600 lbs

*Illustration is for Maximus 46 model

THE B-VENT (IBV) SERIES

Page 15

Assembled Firebox and Smoke Dome Dimensions 36, 42, 46

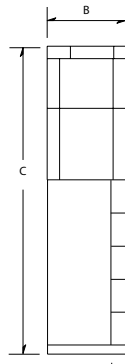

Side View

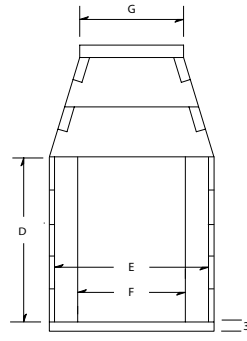

Front View

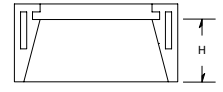

Plan View

Model	A	B	C	D	E	F	G	H	I	Minimum Framing	Weight
36	43"	25 1/4"	71 1/4"	31 1/2"	36 1/8"	27 1/4"	21 1/2"	20 1/4"	5"	(43"w) x (71 1/4"h) x (26 3/4"d)	1500 lbs
46	53"	25 1/4"	71 1/4"	*31 1/2"	47 1/8"	37 1/4"	32"	20 1/4"	5"	(53"w) x (71 1/4"h) x (26 3/4"d)	1700 lbs
*To achieve height dimension "d" in table above, a 100' (8.3') minimum flue height with 10" I.D. B-Vent is required											
36	43"	25 1/4"	81 3/4"	*42"	36 1/8"	27 1/4"	21 1/2"	20 1/4"	5"	(43"w) x (81 3/4"h) x (26 3/4"d)	1650 lbs
46	53"	25 1/4"	81 3/4"	*42"	47 1/8"	37 1/4"	32"	20 1/4"	5"	(53"w) x (81 3/4"h) x (26 3/4"d)	1850 lbs
*To achieve height dimension "d" in table above, a 9' minimum flue height with 10" I.D. B-Vent is required											
36	43"	25 1/4"	92 1/4"	*52 1/2"	36 1/8"	27 1/4"	21 1/2"	20 1/4"	5"	(43"w) x (92 1/4"h) x (26 3/4"d)	1800 lbs
46	53"	25 1/4"	92 1/4"	*52 1/2"	47 1/8"	37 1/4"	32"	20 1/4"	5"	(53"w) x (92 1/4"h) x (26 3/4"d)	2000 lbs

*To achieve height dimension "D" in table above, a 12' minimum flue height with 10" I.D. B-Vent is required

THE VENT-FREE SERIES

Page 17

Typical Vent-Free Dimensions 36, 42, 46

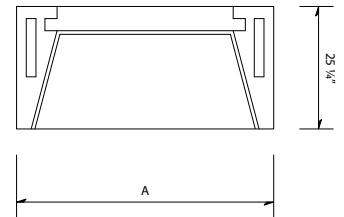
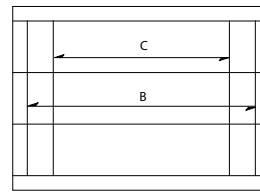
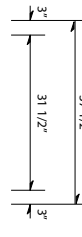
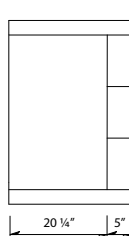

Model	A	B	C	Minimum Framing	Weight
36	43"	36 1/8"	27 1/4"	(43"w) x (37 1/2"h) x (25 1/4"d)	715 lbs
42	49"	43 1/8"	33 1/4"	(49"w) x (37 1/2"h) x (25 1/4"d)	820 lbs
46	53"	47 1/8"	37 1/4"	(53"w) x (37 1/2"h) x (25 1/4"d)	880 lbs

DM 54 CHIMNEY SYSTEMS

Page 23

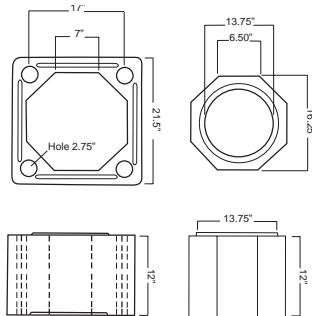

DM APPLIANCE 44 CHIMNEY SYSTEMS

Note: Eco-Steel Chimney Systems and EM40 Mono Chimney Appliance Chimney not shown.

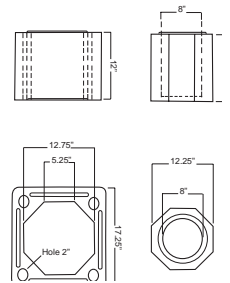

earthcore®

ISOKERN

Multi-Venting Solutions





MULTI-VENTING SOLUTIONS

A gas-fired fireplace creates a flame that's just the right size. Not too high. Not too low. But to achieve the perfect fire, you need the perfect draft. That's why Isokern and Enerflex, two leaders in the fireplace and venting industries, have teamed up to develop the Multi-story Fireplace Exhaust System (MFES). With this innovative technology, a single exhaust system can vent multiple gas-fired fireplaces in a single chimney. This means that up to 25 fireplaces can achieve an optimal draft — regardless of how many fires are burning simultaneously.

Fireplaces usually require individual chimneys. But in multi-story condominiums and apartments, this can greatly impact space allocation and increase costs. The MFES solution, however, allows a single chimney to accommodate multiple fireplaces, eliminating the space constraint while keeping construction budgets manageable.

The MFES is unique in that it monitors the operation of multiple fireplaces in multi-story buildings. Fireplaces are monitored through an integrated electronic system allowing each unit to operate individually.

With a system engineered and installed by Enerflex and fireplaces supplied by Isokern, a multi-vented system for multi-family housing is now more cost-efficient and reliable than ever. For more information, contact our Technical Department.

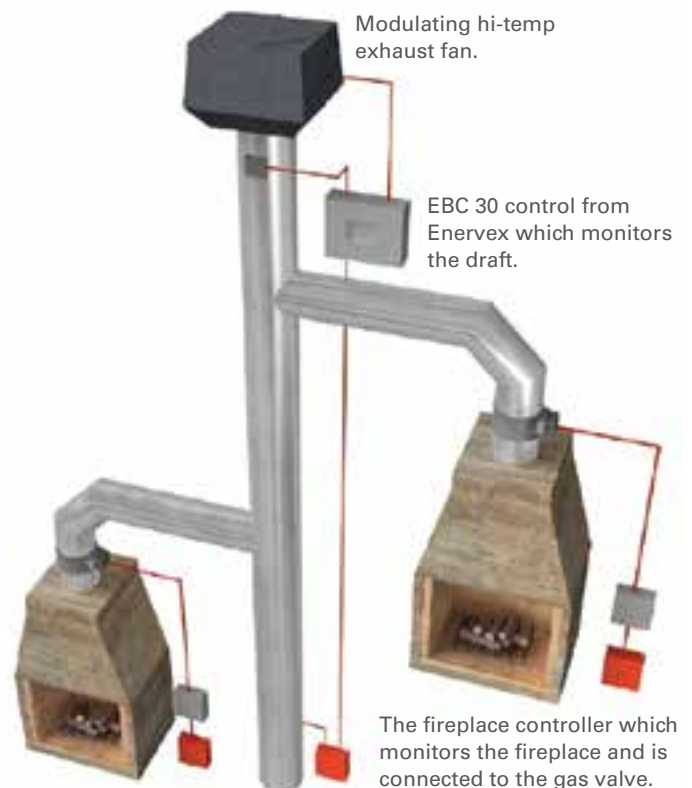

ISOKERN DUAL MODULE (DM) CHIMNEY SYSTEM

Isokern manufactures chimney systems which are impervious to wear and tear. Our Dual Module (DM) Chimney Systems have been venting homes and buildings near the Polar Circle for decades. Over the last quarter century, Isokern Chimney Systems vented over 155 million meters of chimney in North America. Component-based with an inner liner and outer casing, they are the only all masonry chimney system tested and listed to UL103HT (High Temperature) standards. The dual modular design allows for more diverse, lightweight, masonry-type installations and each component is built with tongue and groove construction, enabling a tighter fit for maximum safety and consistent installation. In addition, the DM Chimney System with 100% zero-clearance to combustibles, makes it the easiest flue system to install.

DM54 CHIMNEY SYSTEM

The most popular and widely used Isokern Dual Module Chimney System is up to 14" inside diameter.

The 14" should be used on all of the larger boxes, such as the 42" - 46" Standards and the 36" - 72" Magnums. Tested and listed to L103HT standards.



Inner Liner



Outer Casing

EM40 MONO CHIMNEY

Our 16" Diameter EM40 Universal Flue is the largest insulating masonry chimney available. With proprietary "Air-Vent" technology, it will not crack like cheaper concrete alternatives. Used exclusively for outdoor applications.



ISOKERN BRICK LEDGE

The Isokern Brick Ledge component is uniquely designed to allow a brick or stone chimney to exit out through the roof for interior fireplace installations. This component eliminates the cost of having excess masonry carried down to the footer, a major cost saver to the consumer.



DM44 APPLIANCE CHIMNEY (WOOD STOVE USE)

The ultimate modular masonry appliance chimney system. Created by Isokern and rated at UL 103HT, DM44 Appliance Chimney System can be used for Wood Stoves, Boilers, Pellet Stoves, Masonry Heaters, Boilers, Oil Furnace and Oil Hot Water Heaters with an 8" inside diameter.



ISOKERN OFFSET BLOCK

Isokern Offset Blocks offer the ability to move a vertical chimney from side to side, allowing it to pass objects above the firebox. Many current architectural specifications require a diverse chimney system to allow for more custom applications.



ECO-STEEL VENTING SOLUTIONS

The lightweight Isokern Eco-Steel Venting Solution was created so each flue section connects securely using a unique locking-tab design — ensuring intermediate, tight assembly. Rated for any solid fuel Isokern fireplace, this versatile system has been tested and approved for use with Isokern Standard, Magnum, and Fire-Lite fireplaces.



earthcore[®]
ECO-STEEL
Venting Solutions



48" CHIMNEY SECTION



36" CHIMNEY SECTION



18" CHIMNEY SECTION



12" CHIMNEY SECTION



30 DEGREE OFFSET



15 DEGREE OFFSET



ANCHOR PLATE



ANCHOR PLATE WITH DAMPER



FIRESTOP



CHIMNEY CAP



WALL BAND



STORM COLLAR



earthcore®

ISOFLAMES

All the beauty of a natural wood fire with all the benefits of gas. Convenient, durable and realistic, Isoflames gas logs are made to look like actual wood — including cracks, fibers, circles, bark and knots. So realistic, they look like they were made by Mother Nature herself. Made from a special high heat material, each log allows for a greater radiant temperature, offering a more efficient burn, while adding more warmth to your home.



LINEAR BURNER SOLUTIONS ©

Much like the people who enjoy them, each fire has a look, personality and style all its own. At Earthcore, we believe fireplaces should be equally unique. Isoflames now offers a fully customizable Linear Burner System.

Remarkably versatile and flexible, this system allows for infinite design options, so the fireplace can truly reflect the mood of the room. A favorite in commercial projects, such as hotel lobbies, resorts, lodges and residential projects, you can choose from small and intimate looks to massive 12-foot long openings. Our team of professionals is ready to assist you in bringing your creative vision to life. Each burner comes with a wall switch or remote for the ease of quick start.

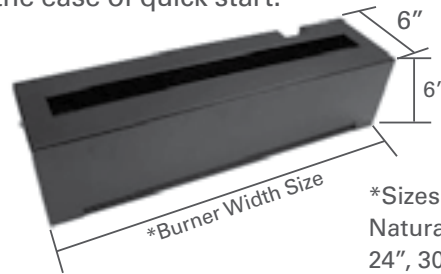

*Sizes Available in
Natural Gas or Propane:
24", 30", 36", 42", 48", 60", 72"



THE STADIUM BURNER

Banging rocks. Rubbing sticks together. Early man used crude methods to create fire. Today, Earthcore has evolved the art form, allowing you to start a fire whenever you want with the push of a button. The Isoflames Stadium Burner has a Remote Electronic Ignition with an optional wall switch. This reversible set provides two classic presentation options — Oak and Split Oak. The burner, created in our Grand Stand design, provides a hidden valve with no unsightly electronic black box. Built with high-efficiency variable technology, these logs are both impressive and efficient. Using less BTU's while achieving a greater flame.



Oak



Split Oak

Sizes Available:
24", 30"



earthcore®

ISO'VEN

Transform your backyard into your own personal pizzeria. Putting a new twist on an old tradition, Earthcore's Iso'ven Wood Burning Pizza Oven can be installed in a matter of hours. To achieve this, we use only the finest insulating and lightweight materials. And, as with all Earthcore products, it's designed to last a lifetime. This perfect marriage between old world style and modern technology makes the perfect pizza a delicious reality.

ISO'VEN WOOD BURNING PIZZA OVEN

Fresh mozzarella. Ripe, red tomatoes. Extra virgin olive oil. There are many ingredients that go into making the perfect pizza. But for that authentic, Neapolitan-style crust, there is nothing better than a real wood burning oven. Introducing the Earthcore Iso'ven Wood Burning Oven, the user-friendly, remarkably affordable outdoor wood burning pizza oven made from our exclusive volcanic material. Created for easy installation, the quick-fire Iso'ven heats up to **800 degrees in an hour**. The Iso'ven Wood Burning Pizza Oven comes with everything you need to get started, including an accessory package of helpful cooking tools.

Includes:

Proprietary Oven Liner
Refractory Mortar
Cooking Surface
Thermometer
Starter Fire Kit

Optional:

Gas Fired Assist
Baking Utensils

Perfect For:

12" Pizza, Bread, Wings and more.



OPTIONAL HOOD

Following the classic approach of traditional wood burning ovens, the Iso'ven is designed to vent through the front. But at Earthcore, we believe customization creates satisfaction. So, if you prefer a flue, we now offer a Hood for Iso'ven designs, giving you the freedom to finish it in your own personal style.



TABLE TOP OVEN WITH OPTIONAL STORAGE BASE

Fires strengthen the bonds between friends and family. Recognizing this, Earthcore developed the ideal companion for your Iso'ven Wood Burning Pizza Oven — our Table Top Oven with Optional Storage Base. Adding a new dimension to backyard dining, it allows you to choose the height of your Iso'ven in relation to the rest of your outdoor kitchen or living space. Installed as-is, with no customization, our Iso'ven base is the perfect height to pair with one of our Isokern outdoor fireplaces.

Visit the Iso'ven Gallery at earthcore.co, for design ideas and to see photos of creative ways that others have used their Optional Storage Base.

Optional Storage:

Ample room for wood, pizza peels, aprons, cooking tools and more.



ACCESSORY KIT

Experience the simple joys of fire in the easiest way imaginable. Enhance your cooking pleasure with the Iso'ven Accessory Kit, which includes a wide array of tools specifically for cooking with your Iso'ven Wood Burning Pizza Oven.

Includes:

Utility Tongs
(2) 12" Pizza Screens
26" Pizza Peel
Stainless Steel Mixing Paddle



earthcore®

ISOPANEL

Take outdoor dining out of the ordinary. Easy to install, eye-catching and completely customizable, the outdoor kitchen can be conveniently installed in less than one day — giving you endless opportunity for designing your outdoor dream kitchen. Using Isokern Panels and Clips, on-site assembly is a breeze and personalization comes with the territory. If you can think it, you can do it.

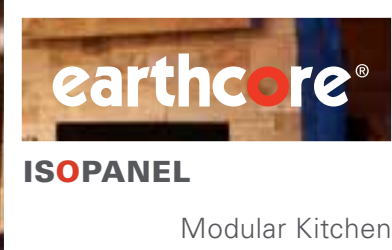

MODULAR KITCHENS

Earthcore has streamlined the construction of building the classic culinary outdoor kitchen for quick assembly. Using our Isokern Panels and Clips, building a beautiful, durable and practical outdoor kitchen is easier than ever. The Isopanel will also support the Iso'ven for added options to construction.



COMPONENTS

ISOKERN PANELS

Dimensions per panel:
2'w x 34"h x 3"d

Use: Each panel weighs only 100 lbs, so they're easily moved when assembling your new outdoor kitchen components.



CLIPS

Use: Slide the appropriate clip over the junction of 2 adjacent panels for holding them together while the mortar is applied.

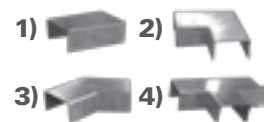

1) Straight 2) 90° 3) 45° 4) "T" clip

EARTHCORE MORTAR ©

Designed to mortar each panel to the floor and to each other. A trowel can be used for initial application. Once the kitchen "base" has been constructed, the disposable mortar bag can be used to fill space between the panels.



FIREPLACE & CHIMNEY ACCESSORIES



ISO-CAP

Specifically designed by Earthcore for the Isokern 14" flue liner, Iso-Cap installation is minimal. Sealed with silicone caulk, each Iso-Cap simply slides into or over the flue.

Available in: Copper, Black Galvanized or Stainless Steel



EM-40 MONO FLUE CAP

Specifically designed for the Isokern 16" EM-40 Mono Flue, this Stainless Cap is used in outdoor only applications and installation is minimal. Sealed with silicone caulk, this cap slides on top of the EM-40 Mono Flue.



EXHAUST FANS

Exhaust fans increase draft when negative pressure is present in the home or building. To guarantee optimum performance, Earthcore exhaust fans come with easy automatic controls.



CROWN CAPS

Prefabricated cementitious weather caps, our DM Crown Caps are designed for DM 54 Chimneys that will receive brick and stone veneers, as well as cultured stone installations. The caps feature an octagonal hole at the center allowing the top inner liner of the DM54 Chimney Stack to pass through. For dimensions varying from large to small, visit our website.



OUTSIDE AIR KIT

Also known as a Fresh Air Intake device, our Outside Air Kits are available with 3" or 4" diameters. These kits help prevent back draft smoking caused by negative pressure in the home while drawing fresh air from the outside to fuel your wood burning fireplace. Outside Air Kits assist your fireplace in burning more evenly. Meeting most building code requirements, they also dramatically reduce pollution and smoke byproducts from your fire.



BOTTOM MOUNT DAMPER

The Bottom Mount Damper is a proprietary design to be used when a conventional poker or top-mount damper is not feasible. Great with **see-through** applications, this type of damper can be paired with either the DM54 or Steel Chimney Systems.

FIREPLACE & CHIMNEY ACCESSORIES

EARTHCORE MORTAR [®]

The Mortar, a thin-set masonry adhesive, can be used in either interiors or exteriors. An approved adhesive for Isokern fireplace systems and DM chimney components, the mortar is available in 50-pound pails. Properly mortared fireboxes and smoke dome assemblies require approximately 5 gallons (dry measure) of mortar.



ISOKOAT BASE COAT

Applied under pressure, Isokoat Base Coat forcibly seeps into cracks and fissures, sealing them, re-pointing the joints and strengthening the wall. Mineral fiber reinforcements in Isokoat Base Coat ensure that wet material will not pour or leak away through larger cracks, but instead fill and bridge those cracks. Using two to four applications, the coating builds up to provide a smooth, gas-tight flue well able to withstand the effects of gases for years to come. Once repaired and sealed, the flue suffers virtually no reduction in size — a very important factor in maintaining proper usage for the appliance served by the chimney.

Isokoat Base Coat is suitable by itself for use in chimneys that don't normally produce high levels of condensation or unusually high acidic flue conditions. This comprises most open fires, including gas burning fires.



FIREBRICK

Typically made of fire clay or siliceous material, our Firebrick is a refractory brick, capable of sustaining intense heat without fusion. And since it's not prone to expansion or contraction, this material helps minimize cracking under extreme heating conditions.

Firebrick is available in either tumbled or square-edged styles, in either red or beige colors. Coloration and size varies slightly.



Colors



beige red

Common Patterns



herringbone stack bond basket weave running bond

There are three standard Firebrick sizes:

- Fulls:** 9" x 4 1/2" x 2 1/2"
- Splits:** 9" x 4 1/2" x 1 1/4"
- Soaps:** 9" x 2" x 1 1/4"

ELEMENTAL CLAY POTS

Exclusively from Earthcore and made from the finest clay, Elemental Clay chimney pots not only enhance your home's exterior, but help in draft efficiency, improving the burn of your fireplace and air quality for the home. Made from high quality clay to maximize the strength and density of each pot produced, our Elemental Clay Pot collection offers various sizes and styles that are both practical and functional.



MANCHESTER
PROD# KUNI

Weight 150lbs
Height 36"
B. Inside Diameter 14"



PORTSMOUTH
PROD# GBUNI

Weight 130lbs
Height 30.5"
B. Inside Diameter 16"



NEWCASTLE
PROD# FCUNI

Weight 130lbs
Height 38"
B. Inside Diameter 17.5"



DORCHESTER
PROD# AUNI

Weight 150lbs
Height 26.5"
B. Inside Diameter 21"



ROXBURY
PROD# FTUNI

Weight 160lbs
Height 37"
B. Inside Diameter 17.5"



FUNI

Weight 110lbs
Height 25"
B. Inside Diameter 17.5"



FSTUNI

Weight 60lbs
Height 18"
B. Inside Diameter 13.5"

ELEMENTAL CLAY CAPS



ROUND
PROD# JLUNI



OCTAGONAL
PROD# JSUNI

ELE-METAL POTS

The wispy heat of a blazing fire rises to infinity, creating a warm bridge between heaven and earth. Our Ele-Metal Clay Pots have all the appeal of our popular traditional clay pots, at a fraction of the weight and cost. Earthcore's Ele-Metal clay pots are fashioned from 24" gauge terracotta colored Kynar steel. They're available in over 28 colors, see website*. And come standard with a 20-year warranty.



PORTSMOUTH
PROD#OCT1930-TC

Weight 37lbs
Height 36"
B. Inside Diameter 17"



DORCHESTER
PROD#SQ-2326-TC

Weight 46lbs
Height 32"
B. Inside Diameter 21"



GLASGOW
PROD#ROU3026-TC

Weight 46lbs
Height 32"
B. Inside Diameter 28"



ONTARIO
PROD#SQOCT-1932-TC

Weight 37lbs
Height 38"
B. Inside Diameter 17"

*For an additional charge.

EARTHCORE FACILITIES

With over 220,000 Isokern installations, Earthcore services over 700 cities throughout the America's. To reach one of our many sales professionals or dealer partners near you, please visit one of our Isokern Solution Centers, call **1.800.642.2920** or visit us on the web at **earthcore.co**.

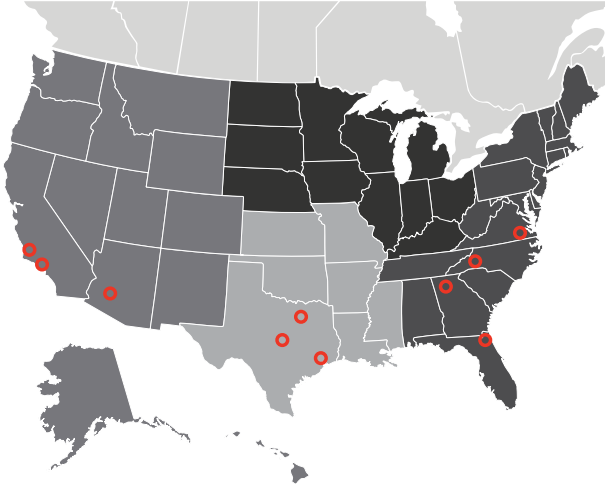

UL Listings and Building Codes

ICC ESR 2316
UL 127
UL 103HT
ULC S610
ANSI Z223.1
ISO 2002 WORLD WIDE
LA RR NO. 25483
NYC-MEA 241-90 E
IMC 2006
IBC 2006
IRC 2006
EPA PHASE 2

WEST DIVISION

South Los Angeles

165 Business Ctr Dr. # 101
Corona, CA 92880
p. 951.738.9702
f. 951.738.9010

North Los Angeles

460 Calle San Pablo #D
Camarillo, CA 93012
p. 805.484.7350
f. 805.484.7360

Phoenix

7910 N. Glen Harbor Blvd.
Glendale, AZ 85307
p. 602.454.0900
f. 602.454.6469

CENTRAL DIVISION

Austin

2101 East St. Elmo Road
Suite #345
Austin, TX 75229
p. 512.443.4400
f. 512.443.4410

Dallas

2128 Crown Road
Dallas, TX 75229
p. 972.247.2311
f. 972.247.1099

Houston

4125 Southerland Road
Houston, TX 77092
p. 713.895.7595
f. 713.895.7747



EAST DIVISION

Atlanta

808 Curie Dr.
Alpharetta, GA 30005
p. 678.566.6602
f. 678.566.6613

Charlotte

2100 N. Davidson Street
Charlotte, NC 28205
p. 704.332.7537
f. 704.332.7538

HEADQUARTERS

Jacksonville

6899 Phillips Industrial Blvd.
Jacksonville, FL 32256
p. 904.363.3417
f. 904.363.3408

MANUFACTURING

Chesapeake

4000 Holland Blvd.
Chesapeake, VA 23323
p. 757.966.7275

earthcore.co

JACKSONVILLE, FL
Corporate Headquarters

CHESAPEAKE, VA
Manufacturing Facility

Branch Locations

ATLANTA, GA	CHARLOTTE, NC	AUSTIN, TX	DALLAS, TX
HOUSTON, TX	PHOENIX, AZ	CORONA, CA	CAMARILLO, CA